



“Be one in a million.”



# PEARL THE CENTRAL PARK

*“Live the Extraordinary”*

30+ Amenities, One project.

# AMENITIES

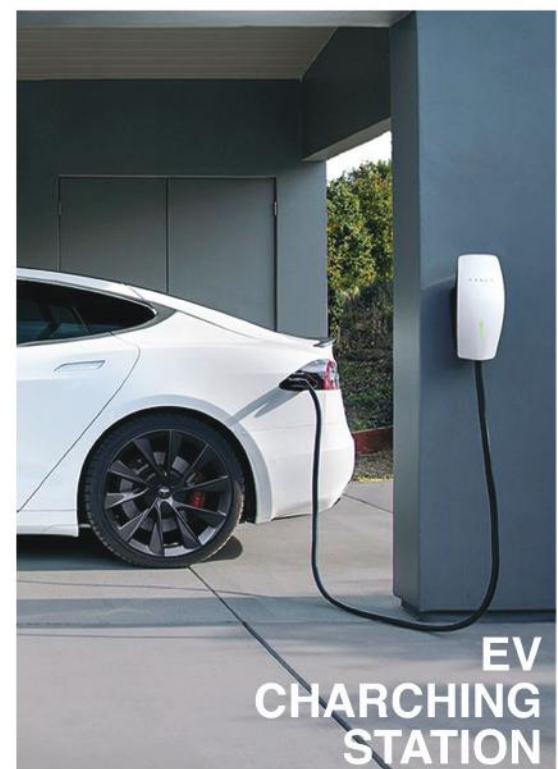
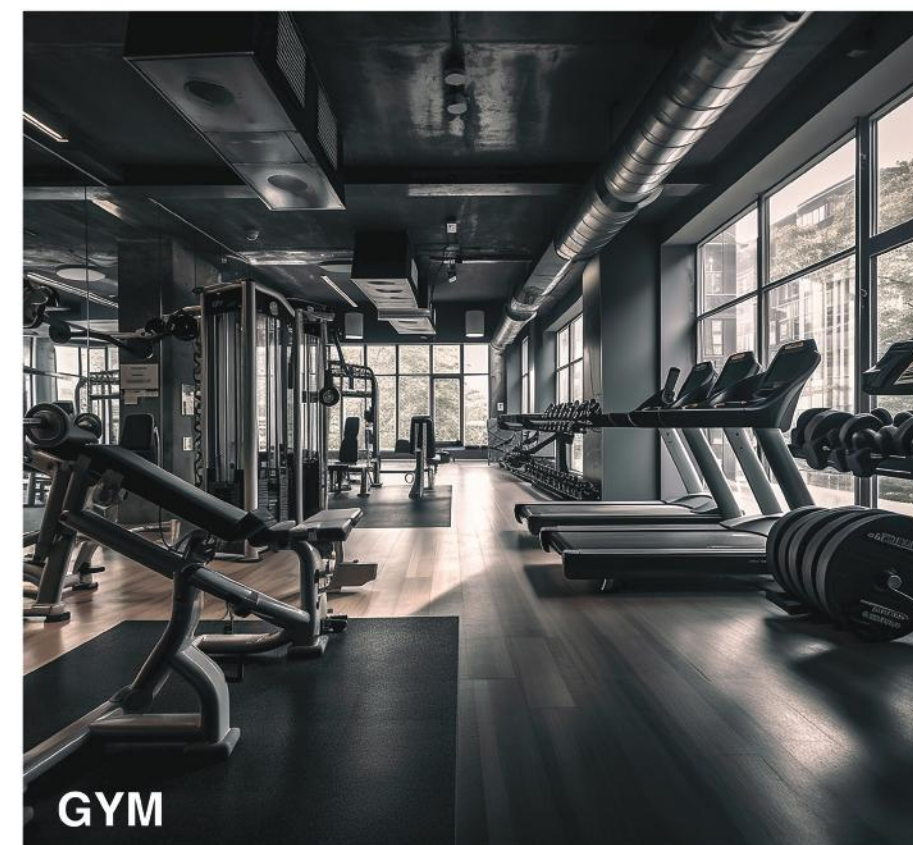

## SPORTS FACILITY



## CLUB FACILITY



# SITE PLAN



## LEGENDS

- |                       |                         |                   |  |
|-----------------------|-------------------------|-------------------|--|
| 01. MAIN ENTRY        | 09. RAMP                | 17. SWIMMING POOL | 25. FUTURE EXPANSION HIGH-RISE BUILDING            |
| 02. COMMERCIAL ENTRY  | 10. CAR PARKING         | 18. KID'S POOL    | 26. KIDS PLAY AREA                                 |
| 03. RESD. ENTRY       | 11. TOWER-A LAWN        | 19. BANQUET LAWN  | 27. OTHER'S PLOT                                   |
| 04. TEMPLE 01(PUBLIC) | 12. SEATING AREA        | 20. CLUB HOUSE    | 28. FUTURE EXPANSION HIGH-RISE COMMERCIAL BUILDING |
| 05. SECURITY ROOM     | 13. SENIOR CITIZEN AREA | 21. SERVICE YARD  | 29. BASKETBALL COURT                               |
| 06. COMMERCIAL PLAZA  | 14. BADMINTON COURT     | 22. SEATING COURT | 30. CUL-DE-SAC                                     |
| 07. HOTEL ENTRY       | 15. SWIMMING POOL LAWN  | 23. TOWER-B LAWN  | 31. LAWN TENNIS COURT                              |
| 08. LAWN              | 16. SWIMMING POOL DECK  |                   |  |

# TOWER -A

# TOWER -B

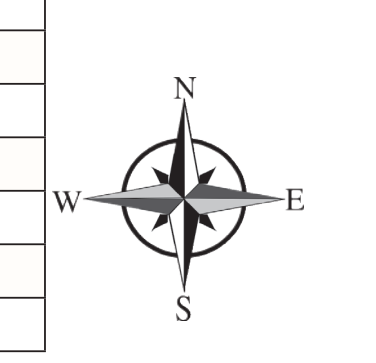
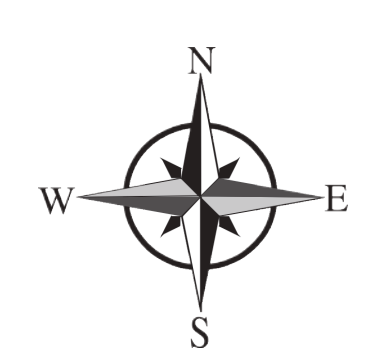
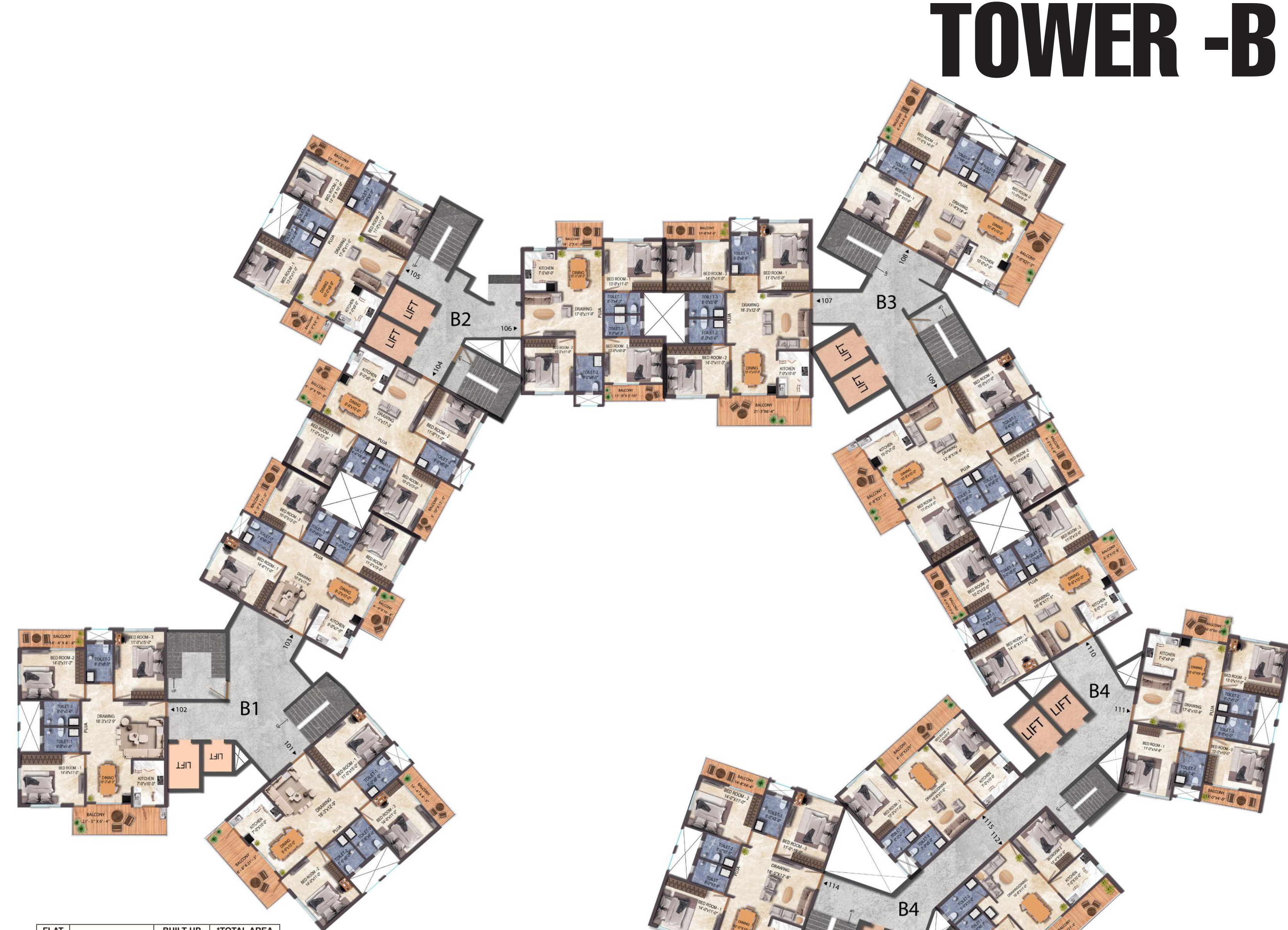

FLAT NO.	TYPE	BUILT-UP AREA (Sqft)	*TOTAL AREA (Sqft)
A1-101	4A 4BHK + 4 TOI. + S.	2594	3502
A1-102	4B 4BHK + 4 TOI. + S.	2299	3103
A1-103	3A 3BHK + 3 TOI. + S	1757	2372
A2-104	3B 3BHK + 3 TOI.	1513	2043
A2-105	3B 3BHK + 3 TOI.	1513	2043
A2-106	3B 3BHK + 3 TOI.	1513	2043
A3-107	3B 3BHK + 3 TOI.	1513	2043
A3-108	4C 4BHK + 4 TOI. + S	2269	3063
A3-109	4C 4BHK + 4 TOI. + S	2269	3063
A4-110	3B 3BHK + 3 TOI.	1513	2043
A4-111	3A 3BHK + 3 TOI. + S	1757	2372
A4-112	3B 3BHK + 3 TOI.	1513	2043
A5-113	4D 4BHK + 4 TOI. + S.	2534	3421
A5-114	3B 3BHK + 3 TOI.	1513	2043
A5-115	3B 3BHK + 3 TOI.	1513	2043

FLAT NO.	TYPE	BUILT-UP AREA (Sqft)	*TOTAL AREA (Sqft)
B1-101	3C 3BHK + 3 TOI.	1362	1838
B1-102	3C 3BHK + 3 TOI.	1362	1838
B1-103	3D 3BHK + 3 TOI.	1163	1571
B2-104	3E 3BHK + 3 TOI.	1124	1518
B2-105	3E 3BHK + 3 TOI.	1124	1518
B2-106	3E 3BHK + 3 TOI.	1124	1518
B3-107	3C 3BHK + 3 TOI.	1362	1838
B3-108	3C 3BHK + 3 TOI.	1362	1838
B3-109	3C 3BHK + 3 TOI.	1362	1838
B4-110	3D 3BHK + 3 TOI.	1163	1571
B4-111	3D 3BHK + 3 TOI.	1163	1571
B4-112	2A 2BHK + 2 TOI.	842	1136
B4-113	3D 3BHK + 3 TOI.	1163	1571
B4-114	3C 3BHK + 3 TOI.	1362	1838
B4-115	2A 2BHK + 2 TOI.	842	1136





FLAT NO.	TYPE	BUILT-UP AREA (Sqft)	TOTAL AREA (Sqft)
C1-101	4E 4BHK + 4 TOL + S.	2322	3134
C1-102	4E 4BHK + 4 TOL + S.	2322	3134
C1-103	4E 4BHK + 4 TOL + S.	2322	3134

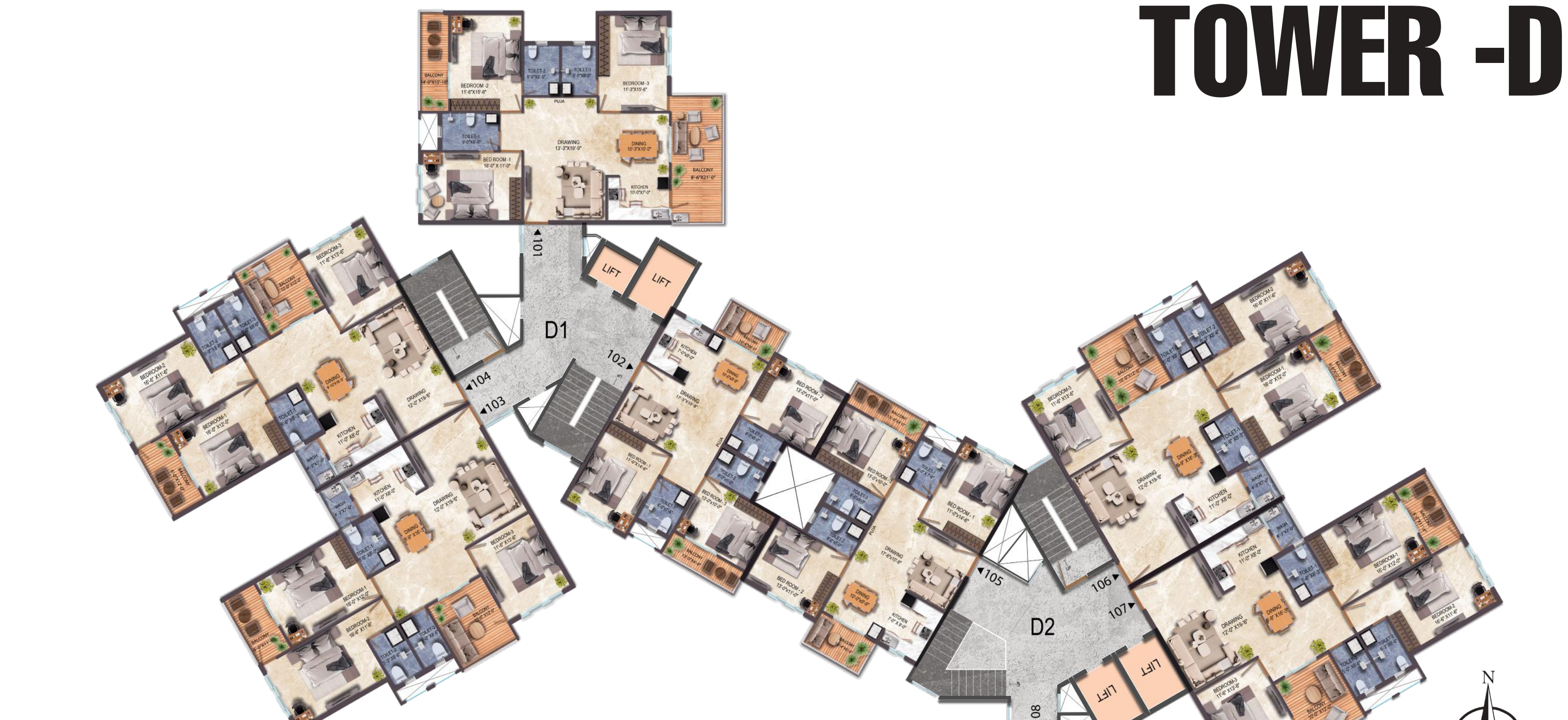

FLAT NO.	TYPE	BUILT-UP AREA (Sqft)	TOTAL AREA (Sqft)
D1-101	3B 3BHK + 3 TOL	1513	2043
D1-102	3D 3BHK + 3 TOL	1163	1571
D1-103	3F 3BHK + 3 TOL	1591	2148
D1-104	3F 3BHK + 3 TOL	1591	2148
D2-105	3D 3BHK + 3 TOL	1163	1571
D2-106	3BHK + 3 TOL	1591	2148
D2-107	3F 3BHK + 3 TOL	1591	2148
D2-108	3D 3BHK + 3 TOL	1163	1571
D3-109	3D 3BHK + 3 TOL	1163	1571
D3-110	3B 3BHK + 3 TOL	1513	2043
D3-111	3B 3BHK + 3 TOL	1513	2043

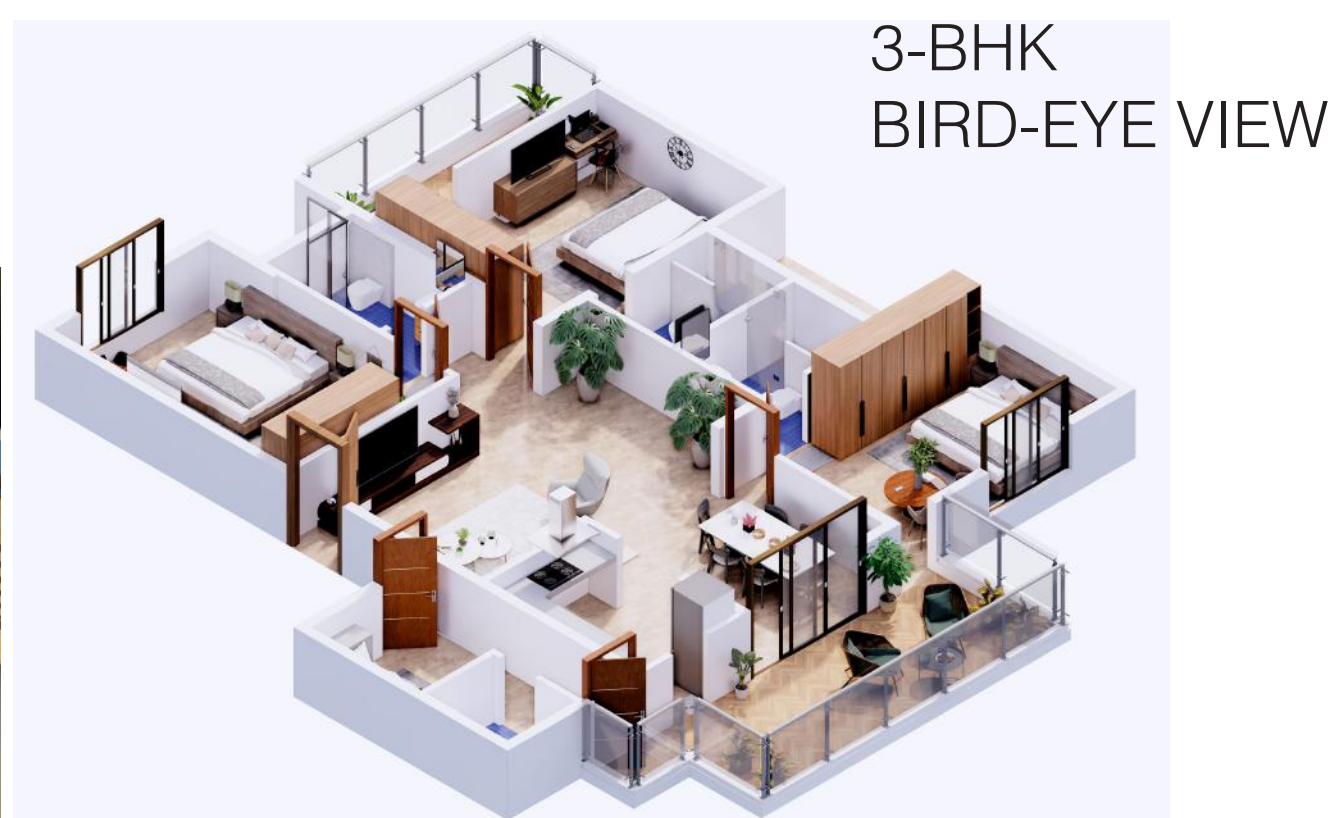

# SPECIFICATIONS

- FRAMED STRUCTURE**  
RCC FRAME STRUCTURE WITH ANTI-TERMITE TREATMENT FOUNDATION.
- FLOORING**  
VITRIFIED TILES FLOORING IN DRAWING / DINING / BEDROOMS OF MAKE ORIENT / NITCO / SOMANY / KAJARIA OR EQUIVALENT.
- DOOR & WINDOWS**  
MAIN DOOR : LAMINATE FINISH BWP GRADE FLUSH DOOR WITH SS HINGES AND WPC CHOWKHAT.  
INTERNAL DOORS : BWP GRADE FLUSH DOOR WITH SS HINGES AND WPC CHOWKHAT.  
ENGINEERED ALUMINIUM / UPVC WINDOWS.
- FIRE SAFETY**  
AS PER NORMS BY THE GOVERNING BODIES.
- LANDSCAPING**  
ADEQUATE GREEN SPACES AS PER THE LANDSCAPE CONSULTANT FIRM.
- LIFT**  
ADEQUATE NUMBER OF STRETCHER LIFT AND 8 PAX LIFTS OF MAKE OTIS / KONE / SCHINDLER/ MITSUBISHI OR EQUIVALENT.
- TOILET**  
CERAMIC TILES ON WALLS UPTO A HEIGHT OF 7FT.  
ANTI-SKID TILES FLOORING.  
ALL SANITARYWARE AND C.P. FIXTURES OF MAKE JAQUAR / HINDWARE OR EQUIVALENT.
- GENERATOR**  
SILENT GENERATOR OF ADEQUATE CAPACITY OF MAKE KIRLOSKAR / MAHINDRA / ASHOK LEYLAND OR EQUIVALENT.
- PARKING**  
ADEQUATE PARKING FOR OWNERS AS WELL AS FOR VISITORS.
- KITCHEN**  
ANTI-SKID TILES FLOORING  
GRANITE COUNTER-TOP WITH SS KITCHEN SINK.
- ELECTRICAL**  
COPPER WIRES OF MAKE CONA / ANCHOR / HAVELLS / L&T OR EQUIVALENT IN CONCEALED CONDUITS AND CONVENIENT PROVISION OF DISTRIBUTION OF LIGHTS AND POWER PLUGS.
- STAIRCASE + LOBBY**  
COMPLETE TILES / MARBLE / GRANITE FLOORING IN STAIRS AND LOBBY.
- EXTRA SERVICE**  
CAR WASH AND ELECTRICAL CHARGING STATION.
- SECURITY**  
CCTV SURVEILLANCE.  
GUARD STATIONS.  
GATED COMPLEX.
- WALL FINISH**  
INTERIOR WALLS : FINISHED WITH POP.  
EXTERIOR WALLS : FINISHED WITH TEXTURED WALL PUTTY & WEATHER-COAT PAINT.
- WATER SUPPLY**  
24 x 7 WATER SUPPLY VIA BUILT OVER-HEAD TANKS SUPPLIED BY BORING.

## SITE ADDRESS



PEARL THE CENTRAL PARK,  
NEAR MOTI FUEL CENTRE,  
ARGORA PUNDAG ROAD,  
ARGORA, RANCHI,  
JHARKHAND- 834002  
CONTACT NO - 9264296043/4, 6203708389



SCAN TO DOWNLOAD BROCHURE

## COMPLETED PROJECTS



## LOCATION MAP

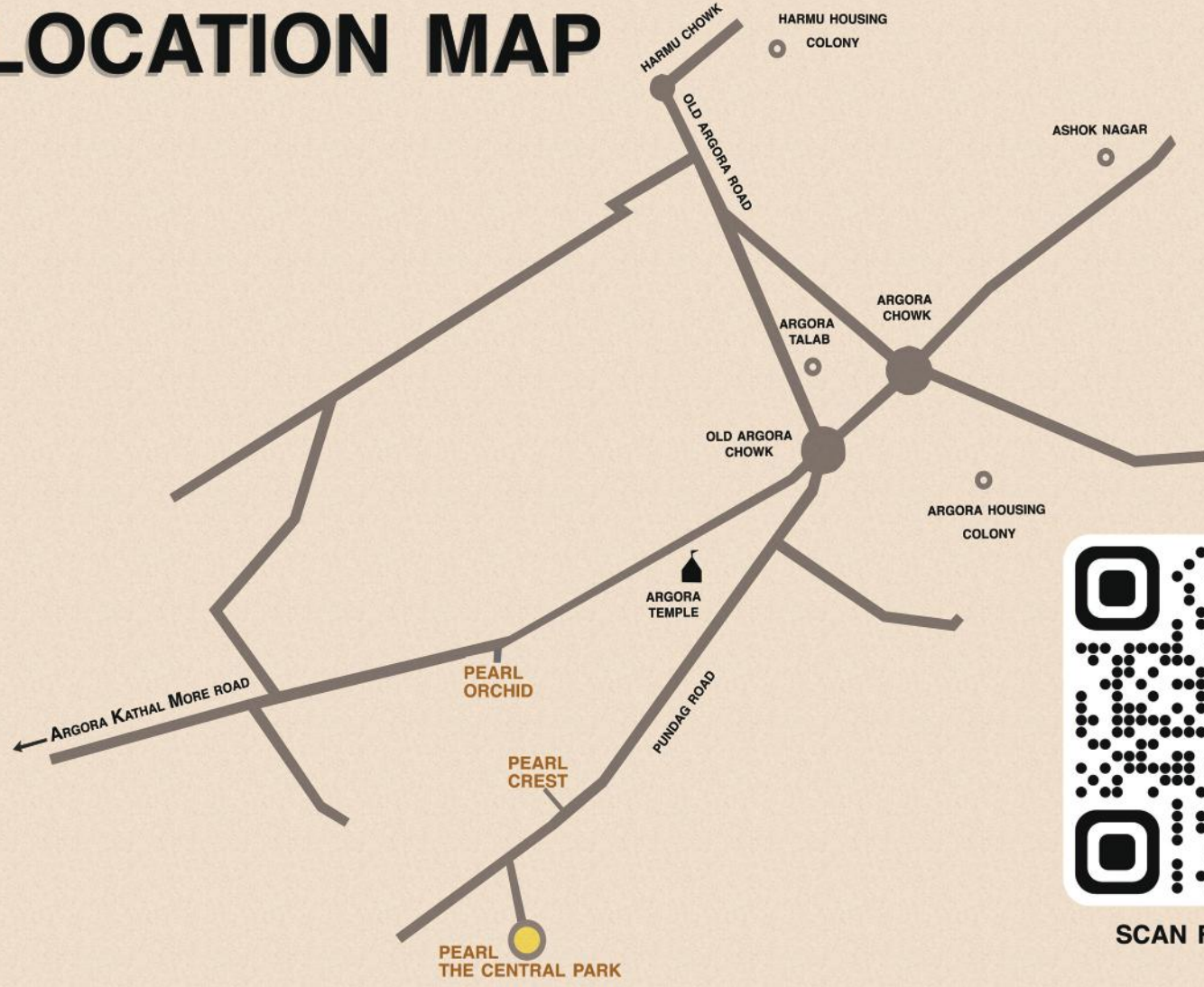

SCAN FOR LOCATION

“PEARL THE CENTRAL PARK”  
DISTANCE FROM

ARGORA CHOWK	RAILWAY STATION	HATIA STATION	AIRPORT	DPS SCHOOL
1.1 KMS	5.1 KMS	6.5 KMS	8 KMS	3.4 KMS

## PEARL CREST



## PAYMENT SCHEDULE

- |      |                                       |      |   |      |  |      |  |
|------|---------------------------------------|------|---|------|--|------|--|
| 20%  | AT THE TIME OF BOOKING                | 20%  | 15 DAYS BEFORE COMMENCEMENT OF FOUNDATION | 5%   | 15 DAYS BEFORE LOWER GROUND FLOOR ROOF CASTING | 5%   | 15 DAYS BEFORE UPPER GROUND FLOOR ROOF CASTING |
| 5%   | 15 DAYS BEFORE 1ST FLOOR ROOF CASTING | 5%   | 15 DAYS BEFORE 2ND FLOOR ROOF CASTING     | 5%   | 15 DAYS BEFORE 3RD FLOOR ROOF CASTING          | 5%   | 15 DAYS BEFORE 4TH FLOOR ROOF CASTING          |
| 5%   | 15 DAYS BEFORE 5TH FLOOR ROOF CASTING | 5%   | 15 DAYS BEFORE 6TH FLOOR ROOF CASTING     | 5%   | 15 DAYS BEFORE 7TH FLOOR ROOF CASTING          | 5%   | 15 DAYS BEFORE 8TH FLOOR ROOF CASTING          |
| 2.5% | 15 DAYS BEFORE 9TH FLOOR ROOF CASTING | 2.5% | 15 DAYS BEFORE 10TH FLOOR ROOF CASTING    | 2.5% | 15 DAYS BEFORE LAST FLOOR ROOF CASTING         | 2.5% | BEFORE POSSESSION OF FLAT/ REGISTRY            |

## CONSULTANTS

ARCHITECT:

ASSOCIATE ARCHITECT:

LANDSCAPE ARCHITECT:

MEP CONSULTANT:

STRUCTURAL CONSULTANT:

3D VISUALIZER:



ARCHITECTS, URBAN PLANNERS



ARCHITECTURE • INTERIOR • LANDSCAPE



ARCHITECTURE | INTERIOR | LANDSCAPE

THIS BROCHURE IS NOT A LEGAL DOCUMENT AND IT ONLY DESCRIBES THE CONCEPTUAL PLAN TO CONVEY THE INTENT AND THE PURPOSE OF MOTI INFRAHEIGHTS PVT. LTD.